

FR 206

SLIDE TYPE:	Regular-Extension Drawer Slide
MOUNTING:	Bottom Mount

WIDTH:	16 mm (0.63 in.)
LOAD CAPACITY:	dynamic up to 100 kg (225 lbs.)



MATERIAL: cold rolled steel, zinc or powder coated

FEATURES: Delrin* encased roller bearings

- SPECIFICATIONS:**
- ▶ stay-closed feature holds the drawer in place when closed
 - ▶ dual detent in the drawer profile holds the drawer in place when extended
 - ▶ with holes for M4 flat head screws
 - ▶ steel rear backstop

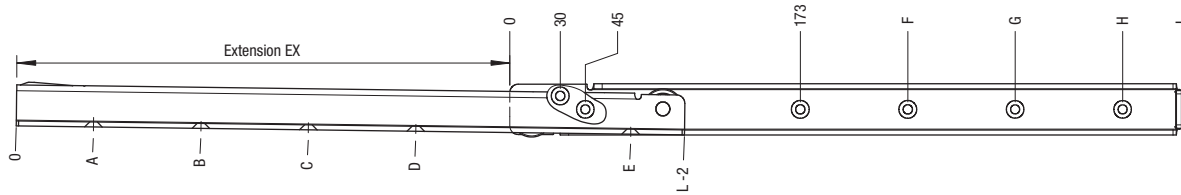
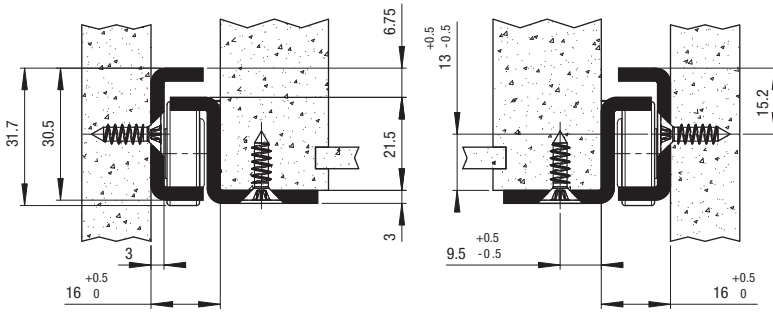

Length L	EX		A		B		C		D		E		F		G		H		Weight		Order No.		
	mm	in	mm	in	mm	in	mm	in	mm	in	mm	in	mm	in	mm	in	mm	in	kg	lbs	zinc	white	
300	11.81	209	8.23	42	1.65	138	5.43	266	10.47				269	10.59					1.48	3.27	4064		
350	13.78	259	10.20	60	2.36	188	7.40	316	12.44				301	11.85					1.71	3.77	4065		
400	15.75	294	11.57	46	1.81	238	9.37	366	14.41				333	13.11					1.94	4.28	4066	4080	
450	17.72	344	13.54	96	3.78	288	11.34	416	16.38				365	14.37					2.17	4.78	4067	4081	
500	19.69	394	15.51	50	1.97	146	5.75	338	13.31	466	18.35		365	14.37	461	18.15			2.40	5.29	4068	4082	
550	21.65	444	17.48	68	2.68	196	7.72	388	15.28	516	20.31		365	14.37	493	19.41			2.63	5.80	4069	4083	
600	23.62	494	19.45	54	2.13	246	9.69	438	17.24	566	22.28		365	14.37	557	21.93			2.86	6.31	4070	4084	
650	25.59	544	21.42	40	1.57	296	11.65	488	19.21	616	24.25		365	14.37	621	24.45			3.09	6.80	4071	4085	
700	27.56	564	22.20	58	2.28	186	7.32	346	13.62	538	21.18	666	26.22	365	14.37	525	20.67	653	25.71	3.33	7.34	4072	4086
750	29.63	614	24.17	76	2.99	204	8.03	396	15.59	588	23.15	716	28.19	365	14.37	557	21.93	685	26.97	3.55	7.83	4073	
800	31.50	654	25.75	62	2.44	190	7.48	446	17.56	638	25.12	766	30.16	365	14.37	621	24.45	749	29.49	3.79	8.36	4074	4087
850	33.46	704	27.72	80	3.15	240	9.45	496	19.53	688	27.09	816	32.13	365	14.37	621	24.45	781	30.75	4.04	8.91	4075	
900	35.43	744	29.29	66	2.60	290	11.42	546	21.50	738	29.01	866	34.10	365	14.37	621	24.45	845	33.27	4.27	9.41	4076	4088
950	37.40	794	31.26	52	2.05	340	11.39	596	23.46	788	31.02	916	36.07	365	14.37	621	24.45	909	35.79	4.51	9.94	4077	
1000	39.37	834	32.83	70	2.76	390	15.35	646	25.43	838	33.00	966	38.03	365	14.37	621	24.45	941	37.05	4.74	10.45	4078	4089

Packing Unit: 300-550 mm 10 pair per box, 600-1000 mm 7 pair per box

*DuPont (TM) Delrin®